

3D SIMO Basic Manual

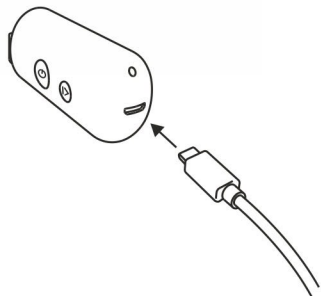

1. We recommend charging the battery after unboxing 3dsimo basic. You can use provided USB cable and plug one end to PC or phone charger and the other one to the back part of the battery.

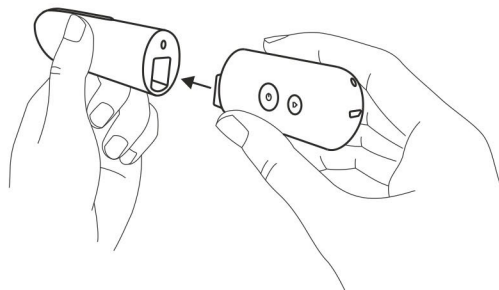

2. Once the battery light turns green, then it is fully charged and you can connect both parts.

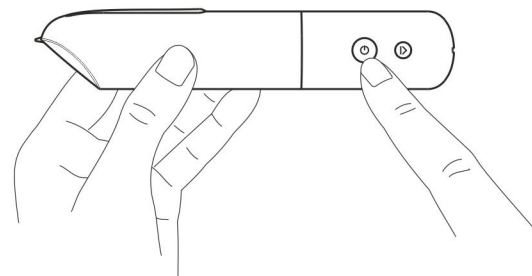

3. When both parts are connected, press the power button and 3Dsimobasic will begin warming up.

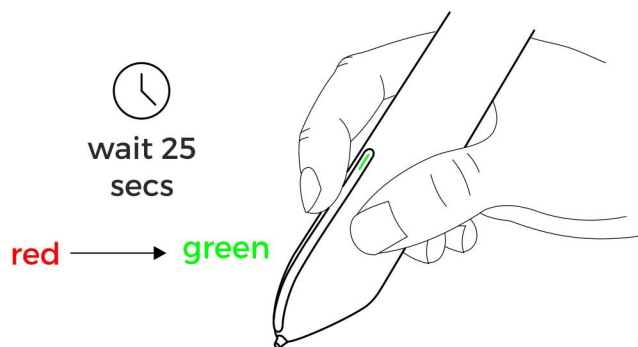

4. Once the front button turns green, then the extruder is heated and ready.

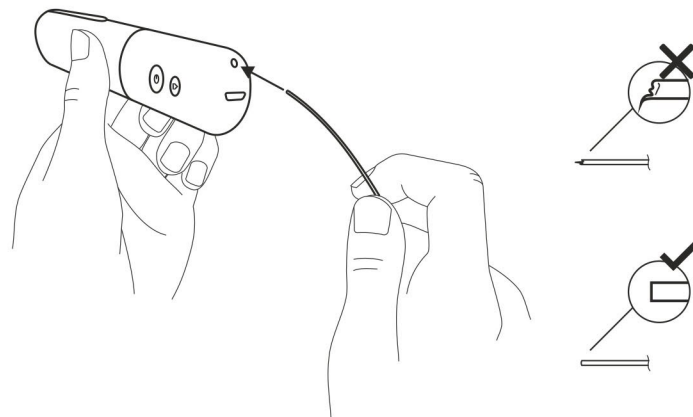

5. Now you can insert a string of PCL material. Make sure that the string is not deformed and its end must be always flat, not jagged. When string is inserted into 3Dsimobasic, hold the front button and gently push the string forward.

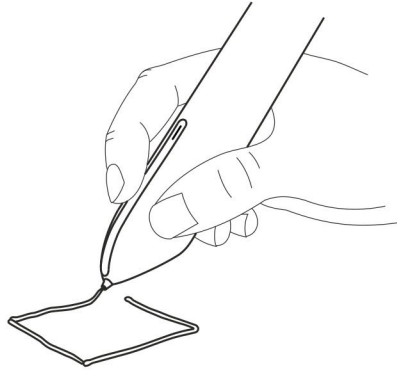

6. String is going to be pulled towards the nozzle and after 8-12 s material will start extruding.

Tip: When holding the front button longer than 10 s, continuous drawing mode will be activated (button light turns blue). Press again once to stop extruding.

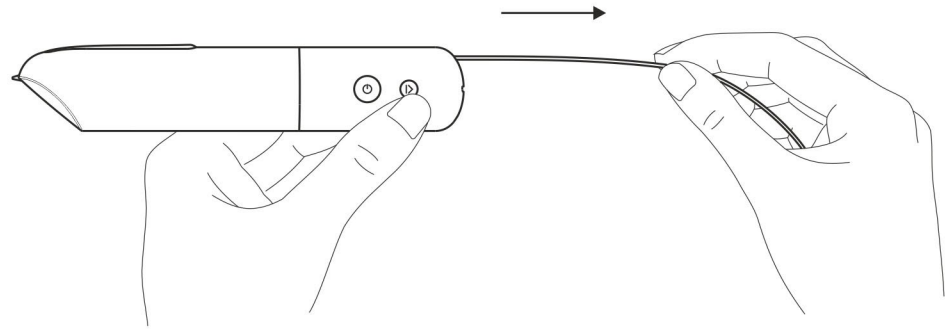

7. To pull the string out, press the reverse button and the whole string will eject by itself.

Certifications

RESTRICTION OF DANGEROUS CHEMICALS

This device meets European directive of Registration, Evaluation, Authorisation and Restriction of Chemicals (REACH) (REGULATION (EC) No 1907/2006 OF THE EUROPEAN PARLIAMENT AND OF THE COUNCIL) and European directive of restriction of the use of certain hazardous substances in electrical and electronic equipment (ROHS) (DIRECTIVE 2002/95/EC OF THE EUROPEAN PARLIAMENT AND OF THE COUNCIL).

CONFORMATION WITH EUROPEAN SAFETY REGULATIONS

This device follows European safety regulations.

Warranty

This device has a warranty period of 12 months. In case of defects or malfunctions send a RMA request to: info@3dsimo.com.